

FORMWORK

Diverter Trim Plates for Thermostatic Systems

INSTALLATION GUIDELINES

Style No. FM2T01

2 Way Diverter Trim Plate for Thermo with Metal Knob Handle

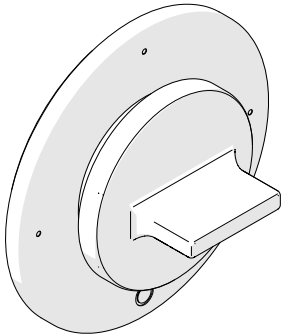

Style No. FM2T10

2 Way Diverter Trim Plate for Thermo with Metal Lever Handle

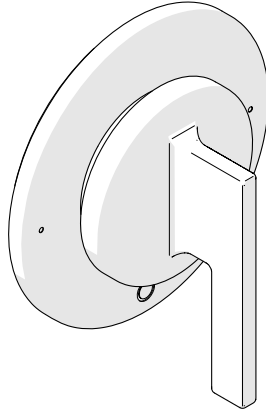

SPECIFICATIONS:

Control Valve Rough-in Depth Minimum: 3-1/8"
Control Valve Rough-in Depth Maximum: 4-3/4"

REQUIRED PLUMBING DETAILS:

Universal Two Way Diverter without Shutoff Valve
STYLE # GUDV14 (SOLD SEPARATELY)

Style No. FM3T01

3 Way Diverter Trim Plate for Thermo with Metal Knob Handle

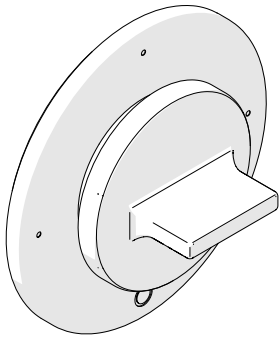

Style No. FM3T10

3 Way Diverter Trim Plate for Thermo with Metal Lever Handle

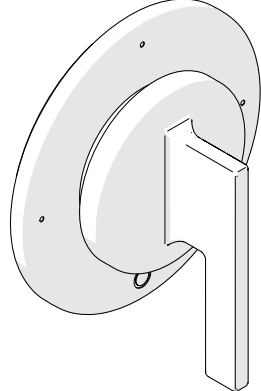

SPECIFICATIONS:

Control Valve Rough-in Depth Minimum: 3-1/8"
Control Valve Rough-in Depth Maximum: 4-3/4"

REQUIRED PLUMBING DETAILS:

Universal Three Way Diverter without Shutoff Valve
STYLE # GUDV66 (SOLD SEPARATELY)

IMPORTANT:

- To ensure this product is installed properly, you must read and follow these guidelines. The owner/user of this product must keep this information for future reference.
- This product must be installed with a Two or Three Way Diverter Valve (SOLD SEPARATELY). Please refer to the specific valve installation guidelines for rough-in requirements.
- Be sure your installation conforms to federal state, and local codes. In the State of Massachusetts, all installations must comply with the rules and regulations set forth within 248 CMR.
- This product must be installed by a professional licensed contractor and must be onsite prior to rough-in, this allows the installer to visualize the installation.
- Inspect this product to ensure you have all the parts required for proper installation.
- Use only a strap wrench or protected/smooth-jaw wrench on any finished surface.
- The use of certain plumber's putty may stain stone or tile surfaces.

DIVERTER VALVE INSTALLATION:

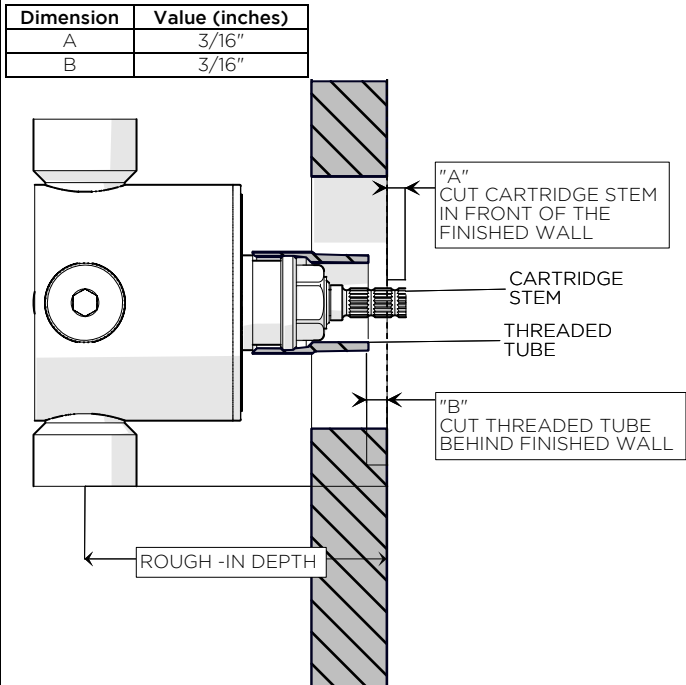

FIGURE - 01

***Warning: If Valve is roughed in too shallow, trim cannot be installed correctly.**

These guidelines have been prepared for the professional contractor to aid in the installation of: FORMWORK DIVERTER TRIM PLATES for THERMOSTATIC SYSTEMS (STYLE# SEE ABOVE) All dimensions are based on original specification and are subject to change and variation. Please consult your Design Associate for current specifications.

WATERWORKS

FORMWORK

Diverter Trim Plates for Thermostatic Systems

INSTALLATION GUIDELINES

➤ See Figure - 01 for steps 1 - 3

1. Pull the tile guard off the **THREADED TUBE** on the diverter valve rough. Mark the **THREADED TUBE** at the finished wall. Unthread the **TUBE** and cut $3/16"$ (**DISTANCE A**) behind the mark.
2. Cut the **CARTRIDGE STEM** $3/16"$ (**DISTANCE B**) in front of the finished wall.
3. After the cuts have been made, thread the **THREADED TUBE** back onto valve body.

TRIM PLATE INSTALLATION:

4. Place **TRIM PLATE** over the modified diverter valve components and hold to finished wall, making sure **FOAM GASKET** is behind it, and thread **TRIM CONNECTOR** onto **THREADED TUBE** as shown in Figure-02.

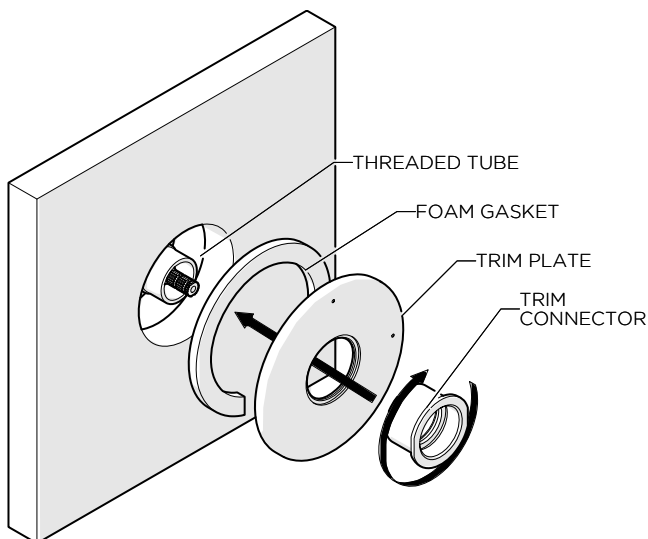

FIGURE - 02

➤ See Figure - 03 for steps 5 & 6

5. Thread **ESCUTCHEON** into **TRIM CONNECTOR** as shown in Figure-03, making sure the **O-RING** is behind the **ESCUTCHEON**.
6. Place **HANDLE** onto **ESCUTCHEON** base making sure **PLASTIC WASHER** is in between. Use **SET SCREW** to secure the **HANDLE** onto **ESCUTCHEON**, as shown in Figure-03.

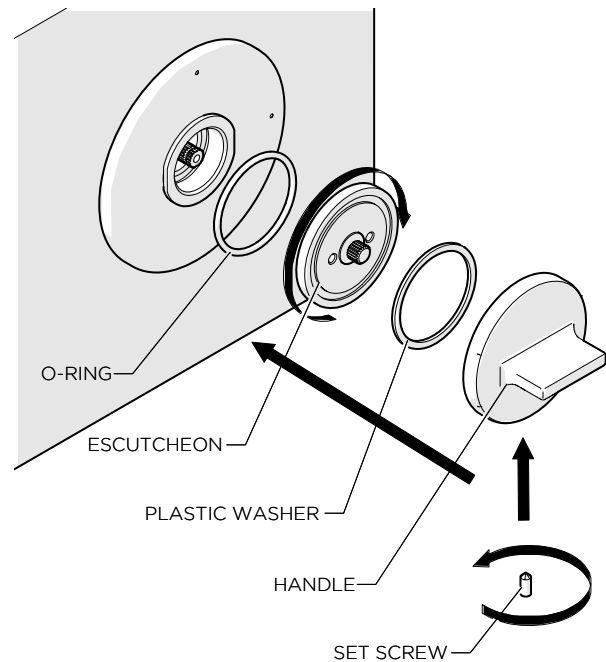

FIGURE - 03

- If further assistance is required, please contact Product Support at 1-800-927-2120 (8am-6pm EST).
- See service part document for parts ordering, available on WATERWORKS.COM

These guidelines have been prepared for the professional contractor to aid in the installation of: **FORMWORK DIVERTER TRIM PLATES for THERMOSTATIC SYSTEMS (STYLE# SEE ABOVE)**. All dimensions are based on original specification and are subject to change and variation. Please consult your Design Associate for current specifications.

WATERWORKS